

Flexible Rubber Joint Single Sphere Electroplated Carbon Steel Flange Connection (XTQ1RF)

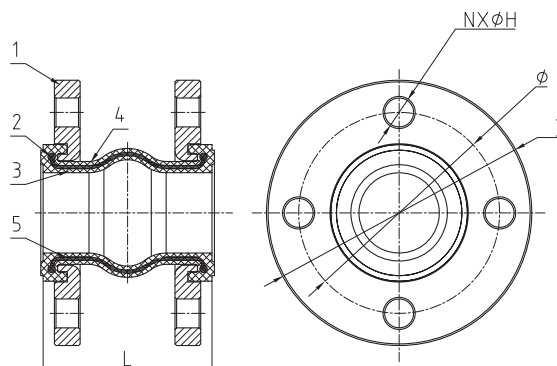

XTQ1RF

- Connection Ends: Flange Drilling to ASME B16.1 CL125
- Working Pressure: 300PSI
175PSI, 200PSI and 250PSI available upon request
- Temperature Range: -10°C - 115°C
- Vacuum Capacity: 700MM/HG



MATERIAL SPECIFICATION

Part No.	Part	Standard Specification
1	Flange	Galvanized Carbon Steel
2	Reinforcing Ring	Carbon Steel
3	Rubber (Inner)	EPDM
4	Rubber (Outer)	EPDM
5	Reinforcing Fabric	Nylon Fabric

Note: For special material request other than standard specification, please indicate clearly on the inquiry or order list.

DN		Neutral Length(mm)				Axial(mm)		Transverse	Angular
Inch	mm	L	D	Ø	N-ØH	Elongation	Compression	Movement(mm)	Deflection Deg.
1 1/4"	32	95	115	88.9	4X15.9	6	10	10	25
1 1/2"	40	95	127	98.5	4X15.9	6	10	10	25
2"	50	105	152	120.7	4X19.1	6	10	10	25
2 1/2"	65	115	178	139.7	4X19.1	8	15	12	25
3"	80	135	191	152.4	4X19.1	8	15	12	25
4"	100	150	229	190.5	8X19.1	12	20	16	15
5"	125	165	254	215.9	8X22.2	12	20	16	15
6"	150	180	279	241.3	8X22.2	12	20	16	15
8"	200	210	343	298.5	8X22.2	12	20	16	15
10"	250	230	406	362	12X25.4	14	30	25	8
12"	300	230	483	431.8	12X25.4	14	30	25	8
14"	350	265	533	476.3	12X28.6	14	30	25	8
16"	400	265	597	539.8	16X28.6	14	30	25	8
18"	450	265	635	577.9	16X31.8	14	30	25	8
20"	500	265	699	635	20X31.8	14	30	25	8
24"	600	265	813	749.3	20X34.9	14	30	25	8

