

PE 100 RC Tees, injected

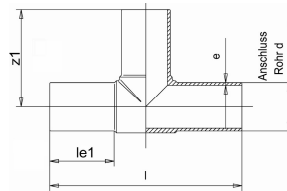

Product image for illustration purposes only.

Product details:

- black
- injected, with elongated spigot, for butt welding and electrofusion welding
- DIN EN ISO 15494/B, DIN EN 12201/3, DIN EN 1555/3

SDR	d (mm)	e (mm)	le1 (mm)	z1 (mm)	Length (mm)	kg/piece	Art. No.
11	20	2.0	41	54	108	0,020	010300713
11	25	2.3	41	60	120	0,033	010300714
11	32	2.9	46	67	139	0,060	010300592
11	40	3.7	52	82	165	0,112	010300593
11	50	4.6	57	92	184	0,187	010300595
11	63	5.8	65	105	216	0,335	010300597
11	75	6.8	72	122	248	0,545	010300128
11	90	8.2	80	137	277	0,940	010300600
11	110	10.0	88	162	321	1,579	010300602
11	125	11.4	98	176	350	2,240	010300129
11	140	12.7	104	200	399	3,180	010300605
11	160	14.6	104	206	413	4,290	010300130
11	180	16.4	143	260	528	6,890	010300131
11	200	18.2	124	253	505	8,330	010300609
11	225	20.5	129	278	559	11,700	010300133
11	250	22.7	132	291	582	13,950	010300135
11	280	25.4	133	312	622	18,860	010300611
11	315	28.6	153	351	690	26,370	010300613
11	355	32.2	167	414	829	38,100	019300087
11	400	36.3	198	457	913	52,010	019300089
11	450	40.9	198	477	954	74,585	019300206
11	500	45.4	218	525	1050	100,000	019300208
11	560	50.8	245	600	1200	142,000	010030447
11	630	57.2	265	650	1300	188,000	010030448
17	50	3.0	57	90	184	0,130	010300594
17	63	3.8	64	106	214	0,238	010300596
17	75	4.5	72	122	246	0,395	010300598
17	90	5.4	81	137	277	0,690	010300599
17	110	6.6	84	161	321	1,120	010300601
17	125	7.4	100	174	345	1,564	010300603
17	140	8.3	104	197	395	2,215	010300604
17	160	9.5	104	206	410	3,010	010300606
17	180	10.7	141	260	525	4,875	010300607
17	200	11.9	123	250	501	5,695	010300608
17	225	13.4	129	276	555	8,260	010300725
17	250	14.8	132	288	576	9,380	010300726
17	280	16.6	132	309	617	12,980	010300610
17	315	18.7	153	346	695	17,650	010300612
17	355	21.1	165	408	818	25,975	019300086
17	400	23.7	197	455	910	36,060	019300088
17	450	26.7	197	478	955	50,615	019300205
17	500	29.7	218	525	1050	68,400	019300207
17	560	33.2	245	600	1200	139,000	010030445
17	630	37.4	265	650	1300	185,000	010030446

All information provided in respect of technical data shall be considered non-binding. This information does not constitute a guarantee of specific properties or qualities and shall not be construed as a warranty in regard to product condition, durability or service life. Subject to modifications and errors. Our standard terms and conditions apply. For further information, please contact our applications engineering team: pipingsystems@simona.de.